



SITE ANALYSIS

Sprinker Recreation Center Site Improvements Project

Pierce County *Parks*

Robert W. Droll,
Landscape Architects, PS

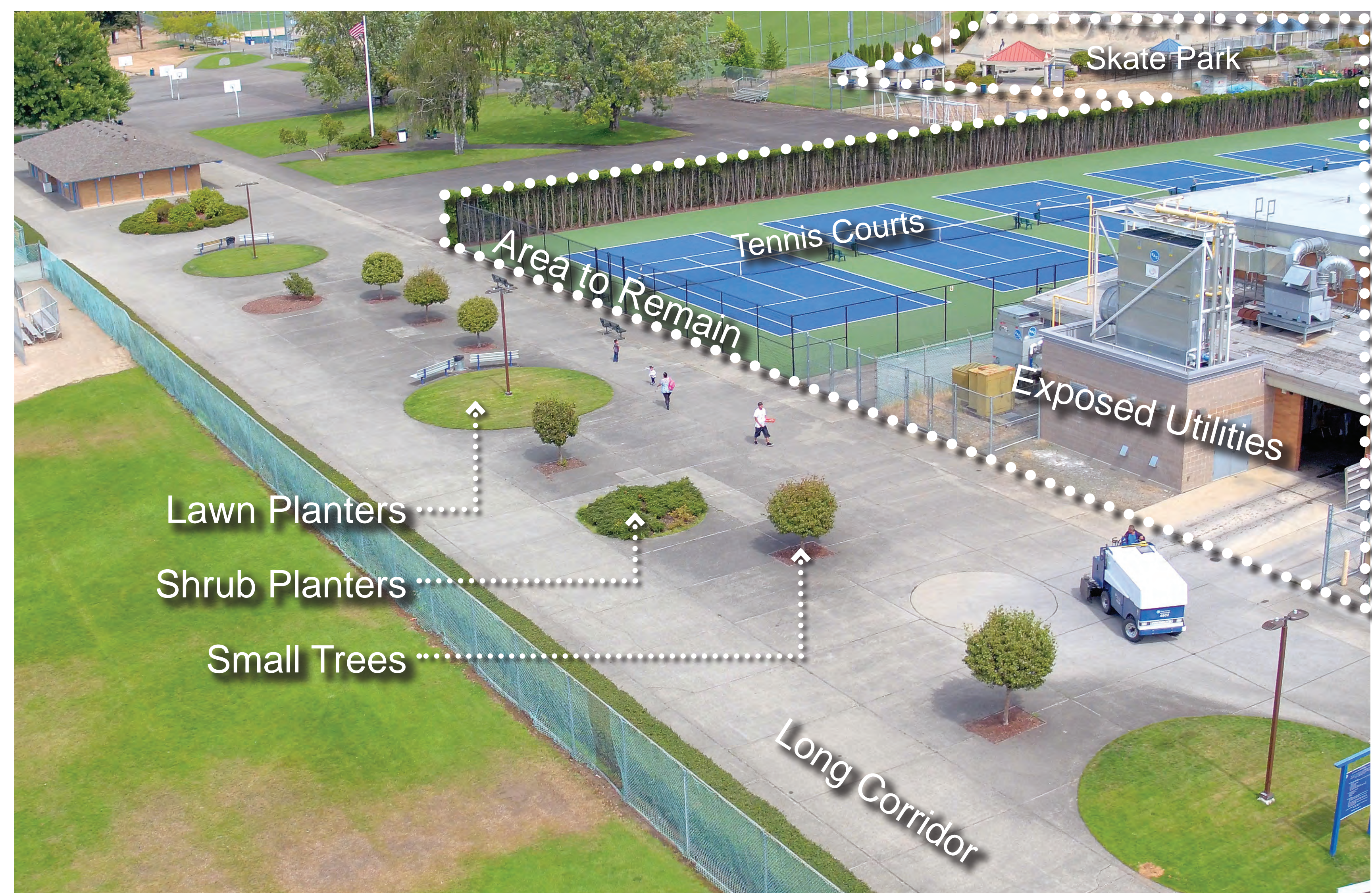



Asphalt Basketball Courts

Aging Equipment



Osprey Pole & Nest



Osprey Nest in Light Pole



Raised Area w/ Steps

Playground Area - No ADA Access



Playground Area - No ADA Access



No ADA Tables

Unused Raised Planters

Small Picnic Area



Picnic Table

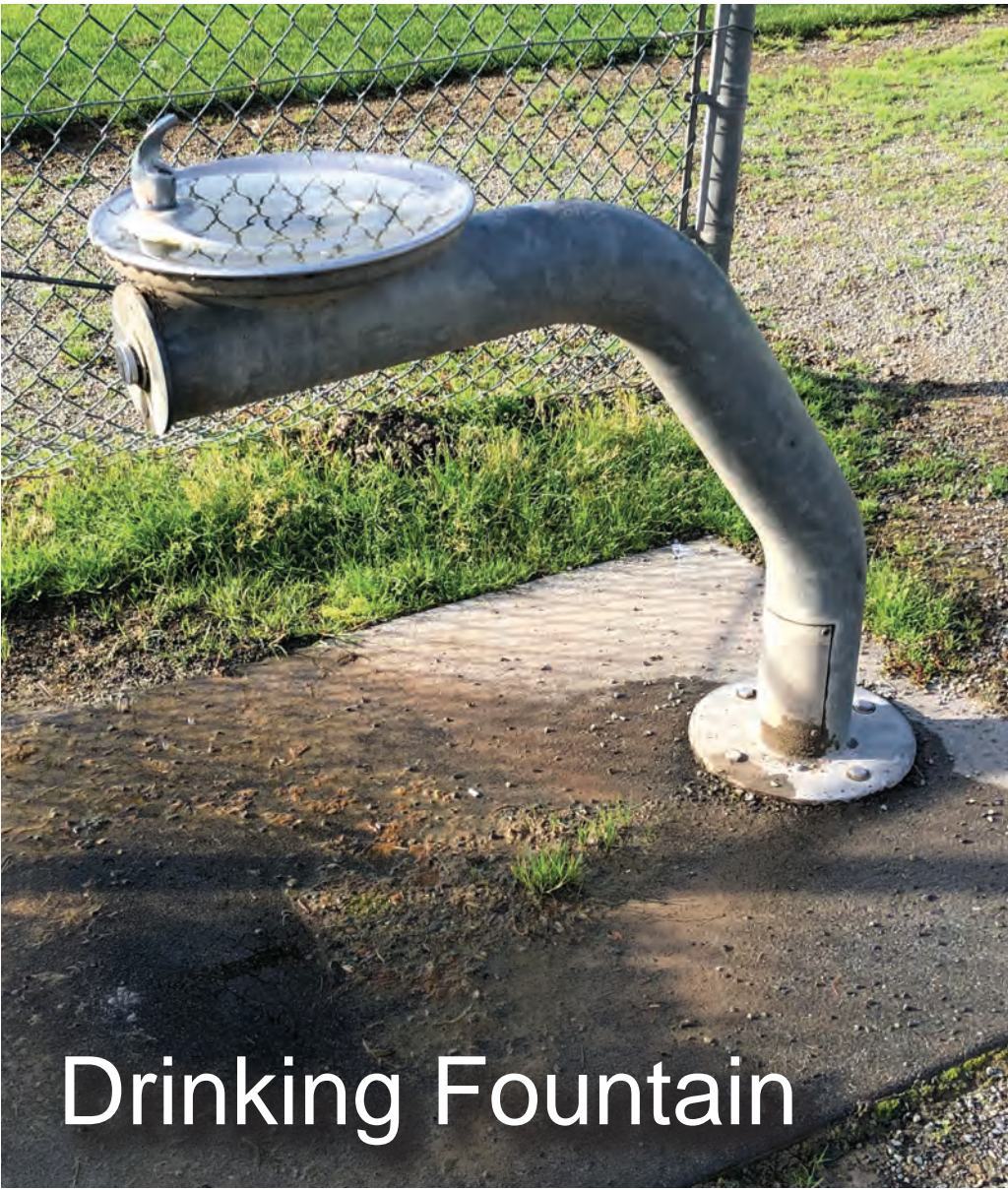

Drinking Fountain



Picnic Table



Dog Bags @ Entry

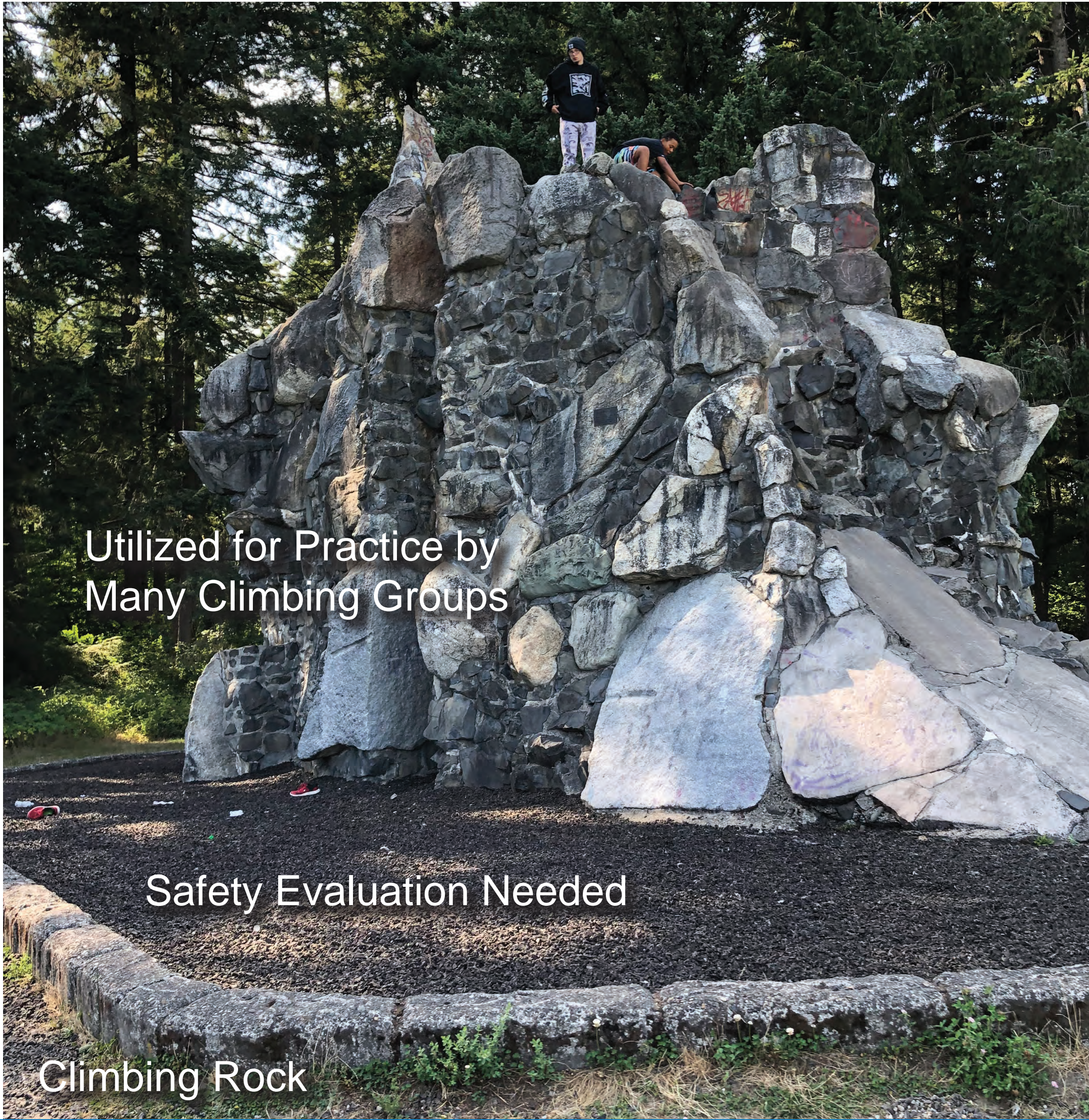

Utilized for Practice by Many Climbing Groups

Safety Evaluation Needed

Climbing Rock



Safety Evaluation Needed

Climbing Rock



Underutilized Space

Stormwater Facility Area



Dog Bags



SITE PHOTOS

Sprinker Recreation Center Site Improvements Project

Pierce County *Parks*





LEGEND

- trees
- shelter
- entry feature
- picnic tables
- open lawn
- buffer planting

KEY

- (A) central entry plaza
- (B) trellis
- (C) parking entrance
- (D) spray & play area
- (E) play area
- (F) multipurpose synthetic field
softball field - 275' outfield
soccer field - 330'x195'
- (G) new softball/baseball fields with
275' & 310' synthetic outfield
- (H) basketball courts
- (I) stormwater detention pond
- (J) building entry plaza
- (K) new maintenance building
- (L) restrooms / concessions
- (M) maintenance yard
- (N) spray park pump house &
utility screening
- (O) pedestrian connection
- (P) climbing structures



CONCEPT MASTER PLAN

Sprinker Recreation Center Site Improvements Project

Pierce County *Parks*

Robert W. Droll,
Landscape Architects, PS



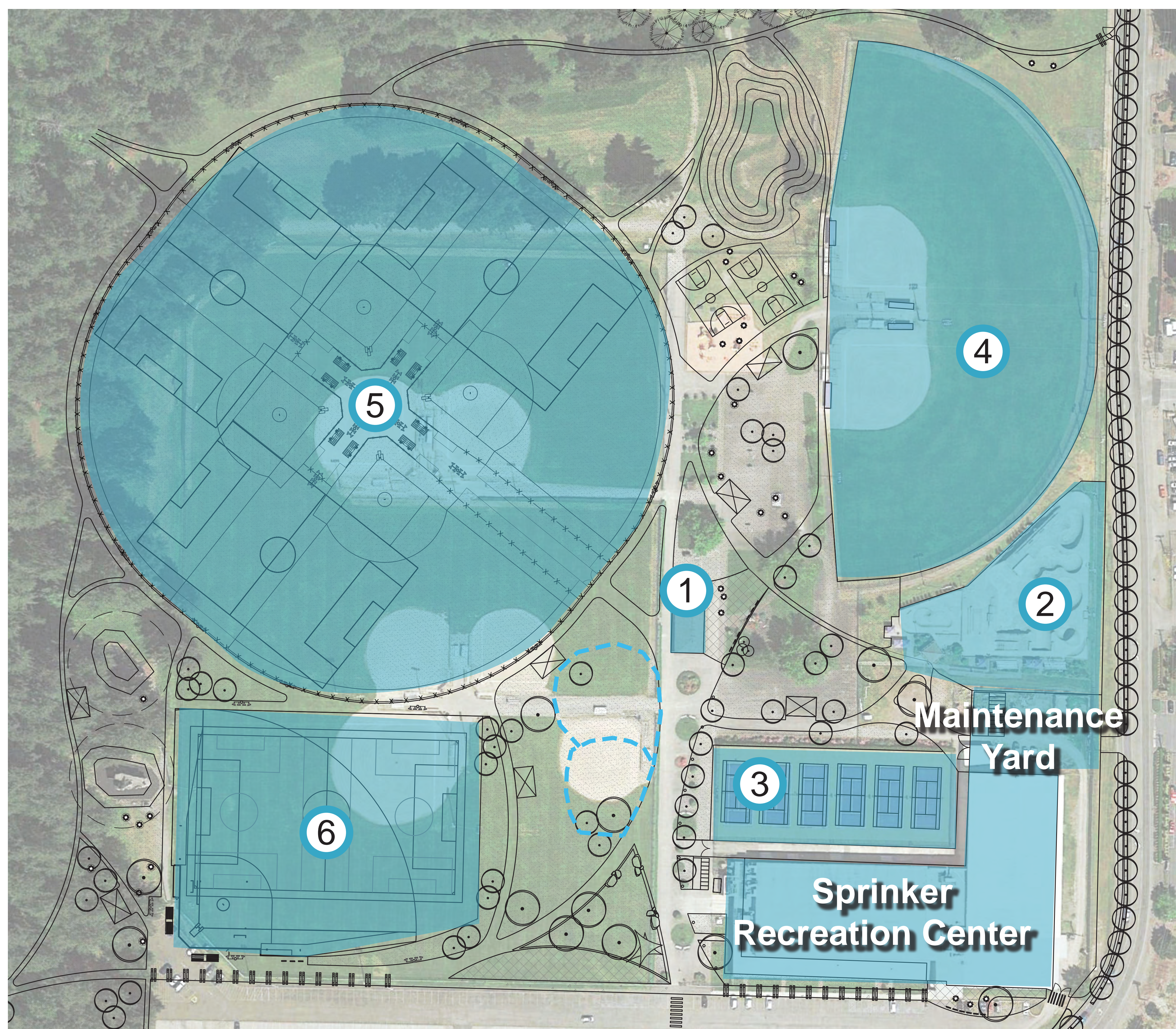

FORMAL PARK ENTRY



Entry Plaza



Entry Sculpture



Entry Plaza

PUBLIC ART



Lighting



Screening



Sculptures

FLEXIBLE EVENT SPACE



Large Events



PROGRAM ELEMENTS
Sprinker Recreation Center Site Improvements Project
 Pierce County *Parks*

Robert W. Droll,
 Landscape Architects, PS



Public Workshop 1 | October 8th, 2019



OPEN LAWN AREAS



PICNIC AREAS



ADA Accessible Furniture



Vibrant Picnic Area



Picnic Shelters



TRAILS



ADA Accessible



Multi-Purpose Trails



PROGRAM ELEMENTS

Sprinker Recreation Center Site Improvements Project

Pierce County *Parks*

Robert W. Droll,
Landscape Architects, PS



Public Workshop 1 | October 8th, 2019

PLAYGROUND



Inclusive Playground



Nature Playground



Multi-Level Challenges



Themed Playground

SPRAY PARK



Themed Splash Pad



WRITE DOWN YOUR OWN IDEAS:



WRITE DOWN YOUR OWN IDEAS:

